

GUTTERCREST

INSTALLATION GUIDE

RAKED & SHAPED BOX GUTTER

BEFORE YOU START

STORAGE

Guttercrest supplies all products with a protective polythene wrapping. If stored outside ensure it is protected from rainfall and direct sunlight as if water gets trapped inside the protective covering and is exposed to warm sunlight then it may leave permanent watermarks on the paint finish. Mill finish items should be stored under cover to avoid uneven oxidization prior to being fitted.

PREPARATION

Ensure the fixing background (e.g. fascia board) is adequate and suitable to fix to (i.e. good condition and securely fixed). The background should be straight and level. The background should be capable of taking the load of a full gutter, snow loads etc.

GUTTER POSITION

Low level gutter

Advantage: Less risk or damage by sliding snow
Disadvantage: The lower the gutter is installed in relation to the roof edge; the higher the risk is of wind driven rain and overshooting rainwater.

High level gutter

Advantage: Protection against wind driven rain.
Disadvantage: High risk of damage by sliding snow.

Guttercrest components are double spigot butt ends.

Please start work from the end / corner, clockwise. Use off cuts for the next adjoining piece of gutter e.g.; Before and after outlets and angles. This minimises waste and cost. Small pieces should not be used 1000mm minimum, off cut other lengths if required. Small pieces create poor aesthetics and alignment.



JOINTING

Before the use of any sealant please ensure all surfaces are perfectly clean and dry.

Use of any sealant must not be carried out in temperatures below 5 °C or above 40 °C. Guttercrest advises and recommends Arbosil 1090 silicone and Arboseal GZ butyl tape to be used to prevent early joint failure.



Low level gutter

Set gutter height by laying a spirit level or straight edge along the pitch of the roof to determine the position of the bracket.



High level gutter

Set gutter height by laying a spirit level or straight edge level against the lowest point of the roof tile to determine the position of the bracket.

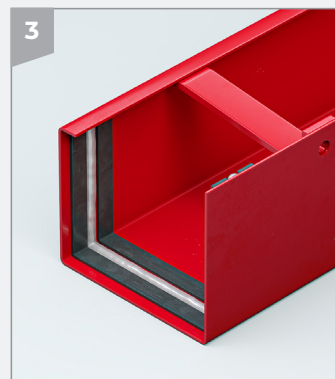

Prior to assembling gutter joints ensure that all fixing surfaces are clean and dry. Apply 2 strips of butyl tape (GM32) 10mm apart inside the female end of the gutter. Fill the 10mm gap generously with silicone sealant (GM30). Do not remove any excess.



Level the first length and fix directly through the cross-brace at the back of the gutter with 38 x 5 stainless steel screws (GM1).

FIXING

It is important that all fixing components are durable and capable of providing necessary support. They must therefore be of the appropriate size and compatible material. Guttercrest recommends 38 x 5 stainless steel screws (GM1) to be used to fix gutters, whether direct, fascia or rafter bracket fixed.

MATERIALS CHECKLIST

Spirit level / straight edge	<input type="checkbox"/>
Suitable screwdriver / attachment	<input type="checkbox"/>
String or laser line	<input type="checkbox"/>
Hacksaw or jigsaw	<input type="checkbox"/>
Tape measure	<input type="checkbox"/>
Mastic gun	<input type="checkbox"/>
Drill with 4.8mm bit	<input type="checkbox"/>
Rivet Gun	<input type="checkbox"/>



GUTTERCREST FIXINGS / SEALANTS

GM1	38 x Nr14 gutter fixing
GM10	4.8mm Ali sealed rivet
GM30	400mm Arbosil 1090 silicone
GM32	12m Arboseal GZ butyl tape
GM40	Touch up paint
GM34	Sealant Cleaner

SYSTEM TESTING

Whilst it would be preferable to water test the rainwater system, under most site conditions this is not practical. If testing is required it should be done when the system is complete.

The outlets should be blocked and the gutters filled two thirds of capacity. After 5 minutes the joints should be checked, unblocking the outlets will test the pipes. Any remedial works should be undertaken, retest until satisfactory.



IMPORTANT Where gutters or fixing are polyester powder coated, cut edges should be deburred and repainted with touch up paint. All rivet heads should also be repainted with touch up paint.



Using a string line or laser level mark the position of the remaining gutter lengths.

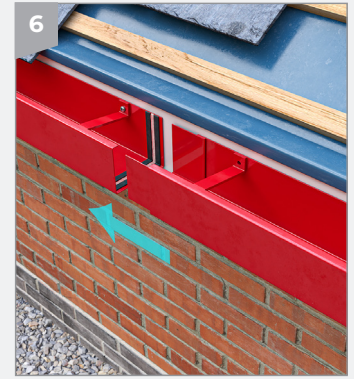

Repeat step 2 then firmly place the male end of the gutter onto the siliconed joint. Ensure the top of the gutters are fully aligned. Screw to secure as explained in step 3.

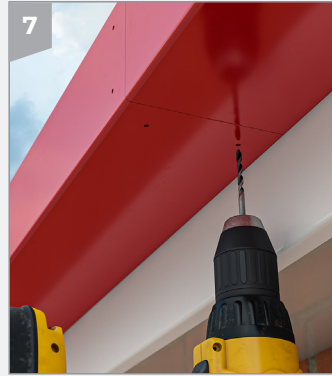

Drill the 4 holes marked with indentations in the first gutter length (female end), two located at the base of the gutter and two in the front.

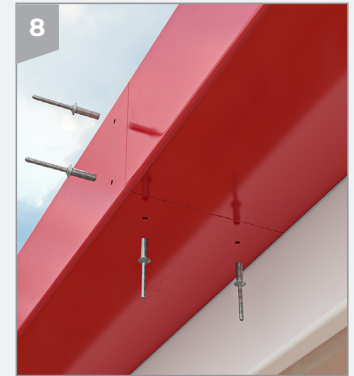

To secure the joining of lengths insert 4.8mm Ali sealed rivets (GM10) through the drilled holes. Use a rivet gun (GM67) to fix the rivets securely.

PLEASE NOTE: Holes should be positioned between the two rows of butyl tape.



Repeat stages 3, 4, 6, 7 and 8 and joint the gutter length to the one previously fixed.