

STANDARD HOPPERS

CODE RWH	H/T	W (mm)	D (mm)	MAX Ø	MAX □																													
RWH200	195	265	205	75	n/a																													
RWH201	230	295	230	100	75 x 75																													
RWH202	300	325	200	150 x 150	RWH203	200	265	220	100	100 x 75	RWH620	185	270	180	100	150 x 100	RWH640	225	430	240	150	150 x 150	RWH660	275	600	275	200	150 x 150	RWH209	180	400	190	125	150 x 100
RWH203	200	265	220	100	100 x 75																													
RWH620	185	270	180	100	150 x 100																													
RWH640	225	430	240	150	150 x 150																													
RWH660	275	600	275	200	150 x 150																													
RWH209	180	400	190	125	150 x 100																													

MAX Ø □ OUTLET SIZE AVAILABLE IN HOPPERS WITH A STANDARD 35MM STANDOFF TO WALL



Fluted
RWH200



Fluted
RWH201



Fluted
RWH202

STANDARD HOPPERS

CONICAL



Conical
RWH203

*FOR CUSTOM
MOTIFS, NUMERALS
OR NAME PLATES ETC.
PLEASE ASK.*

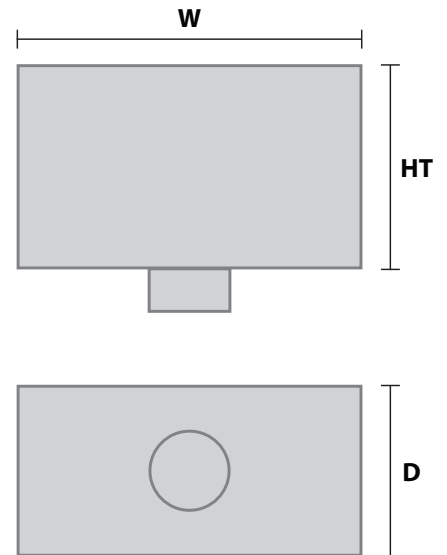

RECTANGULAR



Rectangular
RWH620



Large Rectangular
RWH640

Extra Large Rectangular
RWH660



STANDARD HOPPERS

OUR STANDARD HOPPERS IN DIE CAST ALUMINIUM

CODE RWH	MILL		PPC	
	STANDARD OUTLET	LARGE OUTLET	STANDARD OUTLET	LARGE OUTLET
RWH200	£34.43	-	£35.31	-
RWH201	£40.00	-	£41.14	-
RWH202	£87.14	£94.66	£90.00	£97.52
RWH203	£39.25	-	£40.29	-
RWH620	£41.02	£48.52	£41.81	£49.45
RWH640	£63.20	£70.32	£65.00	£72.12
RWH660	£138.58	£151.14	£142.74	£155.28
RWH209	£69.41	£78.05	£70.82	£79.53
RWH209-1	£69.41	£78.05	£70.82	£79.53
RWH209XL	£89.19	£99.33	£90.73	£100.97

**HOPPER CODES FOLLOWED BY 'L' IS FOR
OUTLETS ABOVE 4" (100mm) DIAMETER.**

**FOR CUSTOM MOTIFS, NUMERALS OR
NAME PLATES ETC. PLEASE ASK.**



Ornate With Motif
RWH209-1



Ornate Plain
RWH209

PLEASE SEE HOPPER POSSIBLE OUTLETS SHEET FOR ALL COMBINATIONS AVAILABLE.

FIXINGS & SEALANTS

Code	Qty.	Description	Price
GM1	25	38mm x 5.5 (No 14 x 1.5") Gutter Fixing	3.15
GM2	100	38mm x 5.5 (No 14 x 1.5") Gutter Fixing	8.62
GM3	200	38mm x 5.5 (No 14 x 1.5") Gutter Fixing	16.05
GM4	25	16mm x No 10 A2 SS Pozi Pan Head Fixing	1.98
GM5	100	16mm x No 10 A2 SS Pozi Pan Head Fixing	4.10

Code	Qty.	Description	Price
GM10	25	4.8mm x 16mm Aluminium Sealed Rivet	1.87
GM11	100	4.8mm x 16mm Aluminium Sealed Rivet	4.58
GM12	200	4.8mm x 16mm Aluminium Sealed Rivet	6.13

Code	Qty.	Description	Price
GM20	25	6 x 30 A2 (Hammer Set) Downpipe Fixing	6.44
GM21	100	6 x 30 A2 (Hammer Set) Downpipe Fixing	22.16

Code	Qty.	Description	Price
GM30	1	380ml Cartridge Silicone Sealant - Grey	4.67
GM32	1	12mtr Reel Butyl Tape 12mm x 3mm	3.30
GM34	1	1 Litre Sealant Cleaner	8.19
GM40	1	0.5 Ltr Touch Up Paint - Colour To Match Order	18.79
GM50	1	Drill Bit 4.8mm	1.54

Code	Qty.	Description	Price
GM55	25	Coping Fixings 8 x 60 A2 (Hammer Set)	9.50
GM56	100	Coping Fixings 8 x 60 A2 (Hammer Set)	33.25

Code	Qty.	Description	Price
GM100	1	Leafguard 200 Wide - 50mtr Roll	150
GM101	1	Leafguard 150 Wide - 50mtr Roll	97.50
GM102	1	Leafguard 125 Wide - 50mtr Roll	97.50

Code	Qty.	Description	Price
GM67	1	Lazy Tong Riveting Tool	46.07



GM30



GM32

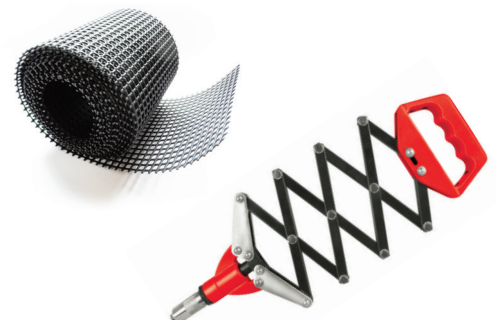

CARRIAGE CHARGES

PLEASE VISIT OUR WEBSITE TO SEE OUR
CURRENT CARRIAGE CHARGES

<https://www.guttercrest.co.uk/delivery/>



These are standard UK delivery charges. For delivery to Scottish Highlands, Northern Ireland, the Republic of Ireland and offshore islands, please call us for a quote +44 (0)1691 663300



Guttercrest Limited

Victoria Road, Oswestry, Shropshire SY11 2HX

T +44 (0) 1691 663300 F 01691 663311

info@guttercrest.co.uk www.guttercrest.co.uk

Due to our ongoing product development policy we reserve the right to alter specifications without prior notice.

E+OE Prices may be subject to change with prior notice.

